

36 1/8

60

BEARING BARS  
1/4 X 6 F.B.

3/8 DIA. RIVETS  
@ 5" O.C.

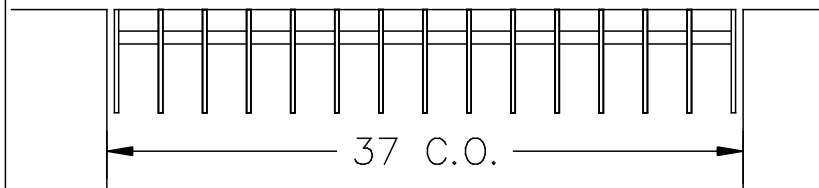

37 C.O.

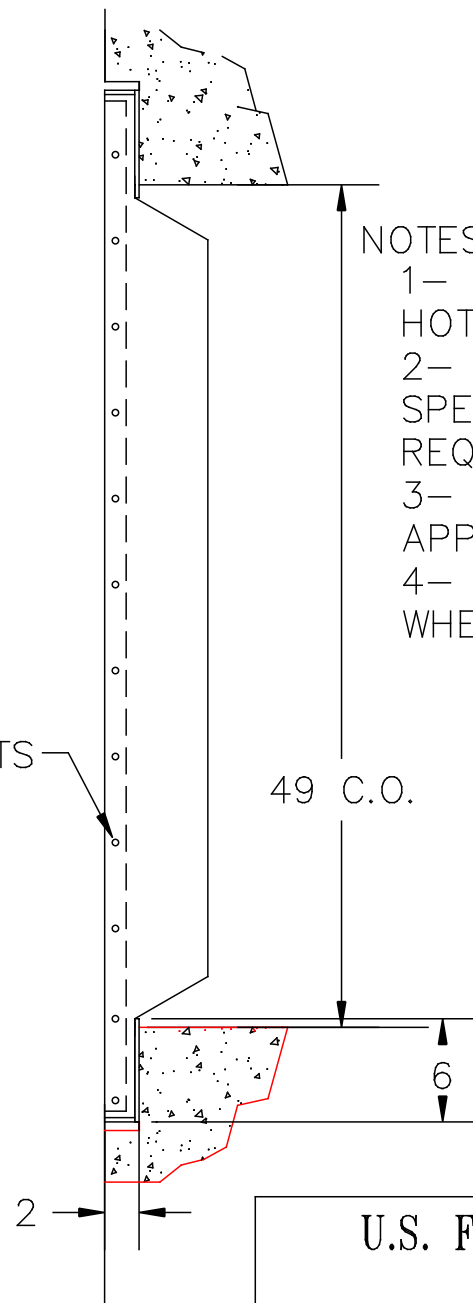

NOTES:

- 1- MATERIAL: STEEL,  
HOT DIPPED GALVANIZED.
- 2- PAINTED TO F.D.O.T.  
SPECIFICATIONS UPON  
REQUEST.
- 3- WEIGHT: 440 LBS.  
APP.
- 4- LOADING: H-20  
WHEEL LOADS.

49 C.O.

6

2

**U.S. FOUNDRY & MFG. CORP.**  
MEDLEY, FLORIDA

USF 6694 STEEL GRATE

DWN. BY:	NKD	SCALE:	1=12	DATE:	4/15/96
CHK. BY:		DWG. NO:	13982	REV:	