

THE INFORMATION CONTAINED IN THIS DRAWING IS THE SOLE PROPERTY OF U.S. FOUNDRY & MANUFACTURING CORP. ANY REPRODUCTION IN PART OR AS A WHOLE WITHOUT THE WRITTEN PERMISSION OF U.S. FOUNDRY & MANUFACTURING CORP. IS PROHIBITED. U.S. FOUNDRY & MANUFACTURING CORP. RESERVES THE RIGHT TO MAKE MODIFICATIONS TO DESIGN WITHOUT PRIOR NOTICE. DRAWING IS UNCONTROLLED WHEN PRINTED. WEIGHTS AND DIMENSIONS ARE PROVIDED FOR REFERENCE ONLY. © 2014 US FOUNDRY AN EAGLE MANUFACTURING COMPANY

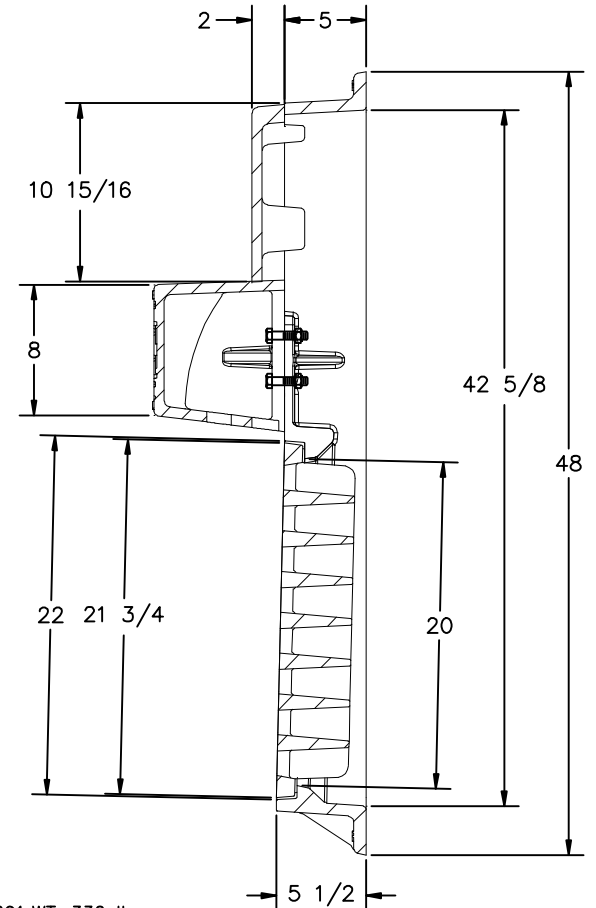
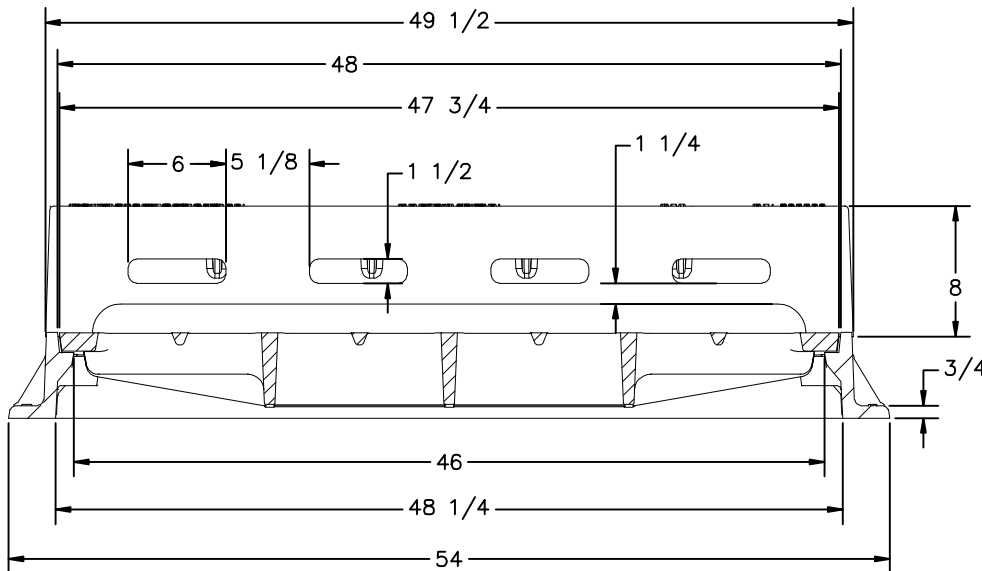
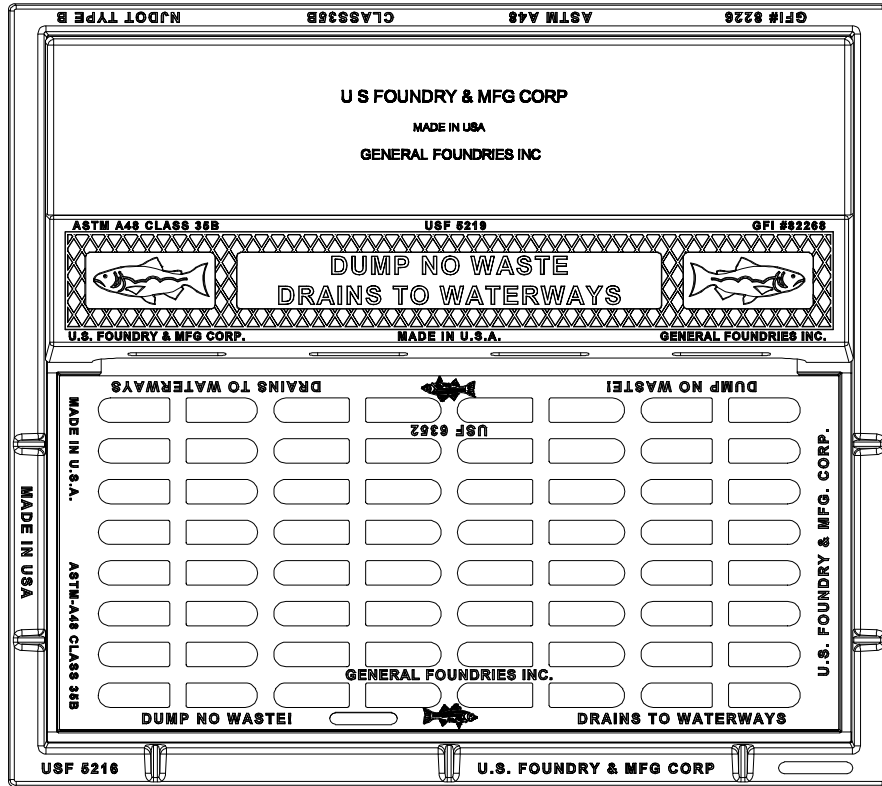

NOTE:
 1-FRAME Baan# 8030291, WT-336 lbs
 HOOD Baan# 8060055, WT-168 lbs
 BACK PLATE Baan# 8015825, WT-125 lbs
 ASSEMBLY FRAME & HOOD Baan# 8050118 WT-504 lbs
 2- TOTAL ASSEMBLY Baan# 8050121 WT-965 lbs
 FRAME, HOOD, BACK PLATE, & GRATE.

US FOUNDRY
 AN EAGLE MANUFACTURING COMPANY © 2014 All Rights Reserved

8351 NW 93rd Street
 Medley, FL, 33166-2025
 ph: 1-800-432-9709
 fax: 305-887-9429
 www.usfoundry.com

USF 5221 Frame, Hood, Back Plate
 & 6352 Grate

LOAD CLASSIFICATION: Heavy Duty			
MATERIAL: ASTM-A48 GRAY IRON CLASS35B			
Frame No:	8050118	SCALE:	1"=1"
Grate No:	8070595	DATE:	01-21-10
Assembly No:	8050121	OWN. BY:	ULS
REV: 3	DATE: 05-14-12	REV BY: ULS	QUOTE#